

All Crash Parts

Brisbane ☎: (07) 3865 2599 Melbourne ☎: (03) 9548 7109

Information Bulletin

Issue raised: **Performance Lighting Fittment**

Date identified: **03/08/04**

Prior to fitting any product in our performance lighting range, we recommend you apply a thin bead of silicone sealant around the perimeter of the lens as a safe-guard against leakage. Ensure that there is no gaps around the lens where the water can seep in. Allow the silicone to touch dry before mounting the lamp. It is also recommended to seal any area where water can pool between the lamp and the vehicle. *See figure 1*

See figure 1

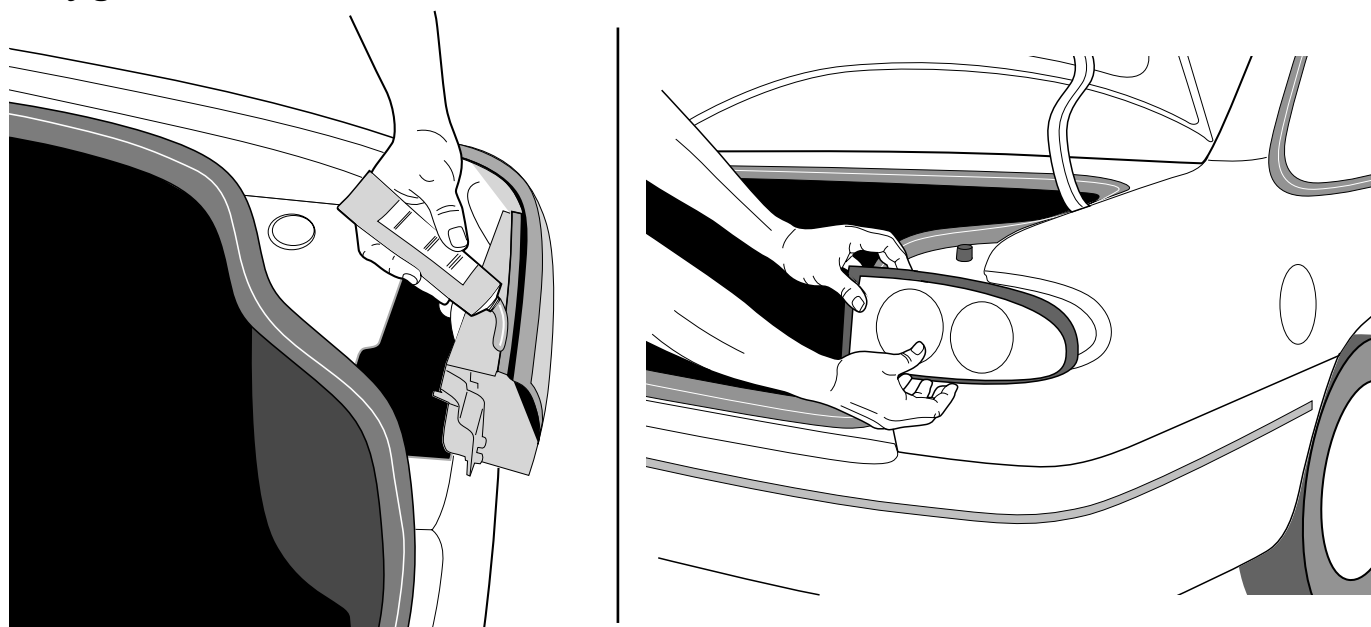

NOTE: The areas to seal will be different for each vehicle. The VR/VS Commodore, shown above, is to be used as an example.